

FAG

6306-2Z

Deep groove ball bearing

Schaeffler ID:
0167231200000Deep groove ball bearing 63...-2Z, single
row, shields, steel sheet metal cage

Technical information

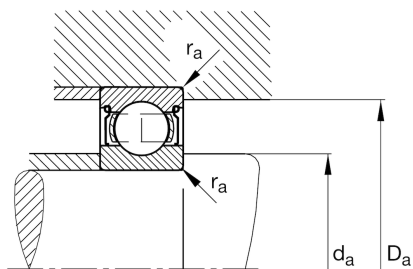
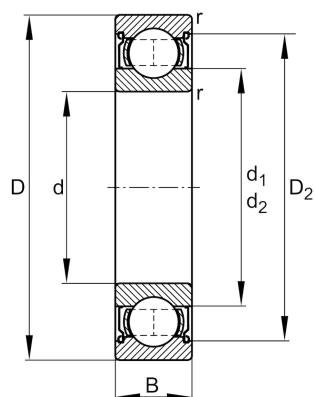
**Dimensions**

r_{\min}	1.1 mm	Minimum chamfer dimension
D_2	61.6 mm	Caliber diameter outer ring
d_1	44.6 mm	Shoulder diameter inner ring
	0.351 kg	Weight

Main Dimensions & Performance Data

d	30 mm	Bore diameter
D	72 mm	Outside diameter
B	19 mm	Width
C_r	30,500 N	Basic dynamic load rating, radial
C_{0r}	16,200 N	Basic static load rating, radial
C_{ur}	1,050 N	Fatigue load limit, radial
n_G	11,700 1/min	Limiting speed
n_{gr}	10,500 1/min	Reference speed

Mounting dimensions

$d_{a\min}$	37 mm	Minimum diameter shaft shoulder
$D_{a\max}$	65 mm	Maximum diameter of housing shoulder
$r_{a\max}$	1.1 mm	Maximum fillet radius

Calculation factors

f_0	13	Calculation factor
-------	----	--------------------

Temperature range

T_{\min}	-20 °C	Operating temperature min.
T_{\max}	120 °C	Operating temperature max.